

Rex Gooding



38 Cambridge Court, Loughborough Road, West Guide Price: £170,000

38 Cambridge Court, Loughborough Road, West Bridgford, NG2 7NN

An immaculately presented two double bedroom ground floor apartment located in the sought after Cambridge Court development. The property is just a moments walk away from all of West Bridgford's local amenities. The property has a good sized living room with french windows looking over the communal water feature, separate kitchen with integrated appliances, modern three piece suite bathroom and two generous sized double bedrooms. The apartment boasts secure gated parking with one allocated space plus additional spaces for visitors.

Accommodation & Amenities

- Ground Floor Apartment
- Entrance Porch & Phone Entry System
- Two Double Bedrooms
- Modern Bathroom With Over Bath Shower
- Secure Gated Development
- Allocated Off Road Parking & Communal Gardens
- No Upward Chain
- Double Glazing Throughout
- Sought after Location
- EPC 73/75

GROUND FLOOR
645 sq.ft. (59.9 sq.m.) approx.

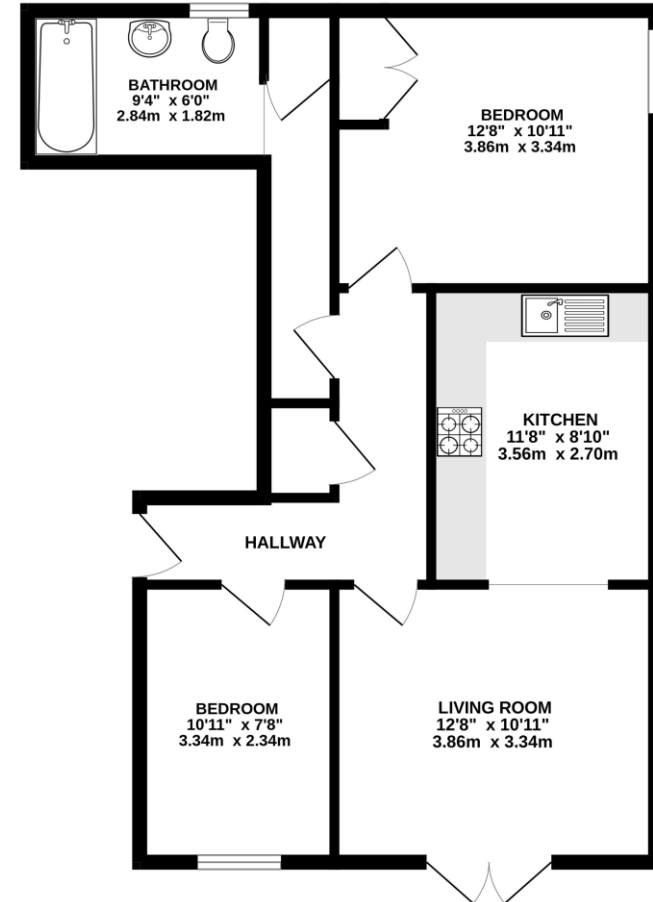

TOTAL FLOOR AREA : 645 sq.ft. (59.9 sq.m.) approx.

Whilst every attempt has been made to ensure the accuracy of the floorplan contained here, measurements of doors, windows, rooms and any other items are approximate and no responsibility is taken for any error, omission or mis-statement. This plan is for illustrative purposes only and should be used as such by any prospective purchaser. The services, systems and appliances shown have not been tested and no guarantee as to their operability or efficiency can be given.
Made with Metropix ©2024



